

Giunti automatici

Push-in couplings
Schnellkupplungen

Dati tecnici dei giunti Germania

German couplings technical data
Technische Daten der Kupplungen Deutschland



Fluido Aria compressa	Fluid Compressed air	Fluid Druckluft
Pressione di esercizio Da 0 a 12 Bar	Working pressure From 0 to 12 Bar	Betriebsdruck Von 0 bis 12 bar
Portata aria 2000 l/min.	Air flow 2000 l/min.	Luftstrom 2000 l/min.
Materiali Ottone ed acciaio	Materials Brass and steel	Werkstoffen Messing und Stahl
Filettatura BSPP cilindrica da 1/4" a 1/2"	Thread types BSPP cylindrical from 1/4 to 1/2"	Gewinde typ BSPP zylindrisch von 1/4" bis 1/2"

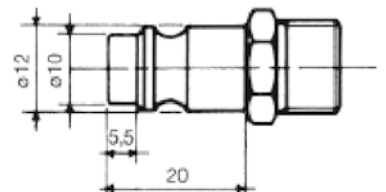

Foro interno d. 7,0 mm
Internal hole d. 7,0 mm

GD 10



Giunto Germania maschio
German male quick coupler
Kupplungen Deutschland

Codice/Code	F"	L	CH		
GD100014	G1/4	52	19		10
GD100038	G3/8	52	19		10
GD100012	G1/2	55.5	22		10

GD 60



Innesto maschio Germania
German male connection
Kupplungen Deutschland

Codice/Code	F"	L	CH		
GD600014	G1/4	33.5	14		10
GD600038	G3/8	35.5	17		10
GD600012	G1/2	38	22		10

GD 20



Giunto Germania femmina
German female quick coupler
Kupplungen Deutschland

Codice/Code	F"	L	CH		
GD200014	G1/4	52	19		10
GD200038	G3/8	55	19		10
GD200012	G1/2	55	25		10

GD 60T



Innesto maschio Germania (acciaio)
German male connection (steel)
Kupplungen Deutschland (Edelstahl)

Codice/Code	F"	L	CH		
GD600014T	G1/4	33.5	14		10
GD600038T	G3/8	35.5	17		10
GD600012T	G1/2	38	22		10

GD 30

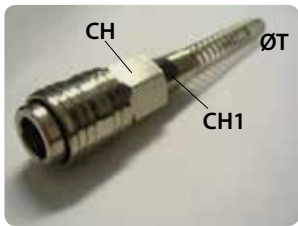

Giunto Germania con molla
German quick coupler with spring
Kupplungen Deutschland mit Feder

Codice/Code	ØT	L	CH	CH1	
GD300406	4x6	118	19	12	10
GD300508	5x8	140	19	13	10
GD300608	6x8	140	19	13	10
GD306510	6.5x10	140	19	15	10
GD300810	8x10	140	19	15	10
GD300812	8x12	146	19	17	10
GD301012	10x12	146	19	17	10

GD 70

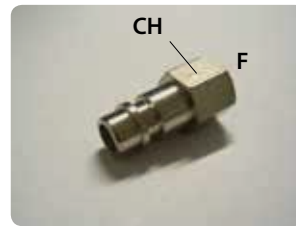

Innesto femmina Germania
German female connection
Kupplungen Deutschland

Codice/Code	F"	L	CH		
GD700014	G1/4	33	15		10
GD700038	G3/8	35	19		10
GD700012	G1/2	38	25		10

GD 40



Giunto Germania con resca
German quick coupler with tail
Kupplungen Deutschland mit Abschluss

Codice/Code	ØT	L	CH		
GD400006	6	60	19		10
GD400007	7	60	19		10
GD400008	8	64	19		10
GD400009	9	64	19		10
GD400010	10	64	19		10
GD400011	11	64	19		10
GD400012	12	64	19		10
GD400013	13	64	19		10
GD400014	14	64	19		10

GD 80



Innesto Germania con molla
German spring connection
Kupplungen Deutschland mit Feder

Codice/Code	ØT	L	CH	CH1	
GD800406	4x6	96	13	12	10
GD800508	5x8	120	13	13	10
GD800608	6x8	120	13	13	10
GD806510	6.5x10	120	15	13	10
GD800810	8x10	120	13	15	10
GD800812	8x12	125	15	17	10
GD801012	10x12	125	15	17	10

GD 50



Giunto Germania portagomma
German quick coupler for rubber tube
Schlauchtulle Kupplungen Deutschland

Codice/Code	ØT	L	CH	CH1	
GD500610	6x10	70	19	15	10
GD500612	6x12	70	19	15	10
GD500614	6x14	70	19	17	10
GD500812	8x12	70	19	15	10
GD500817	8x17	70	19	20	10
GD501019	10x19	76	19	22	10

GD 85



Innesto Germania portagomma
German connection for rubber tube
Schlauchtulle Kupplungen Deutschland

Codice/Code	ØT	L	CH	CH1	
GD850610	6x10	50	15	13	10
GD850612	6x12	50	15	15	10
GD850614	6x14	50	17	17	10
GD850812	8x12	50	15	13	10
GD850813	8x13	50	16	13	10
GD850817	8x17	50	13	20	10
GD851019	10x19	54	13	22	10

Giunti automatici

Push-in couplings
Schnellkupplungen

GD90



Innesto Germania con resca

German connection with tail
Kupplungen Deutschland mit Abschluss

Codice/Code	ØT	L			
GD900006	6	40			10
GD900007	7	40			10
GD900008	8	41			10
GD900009	9	41			10
GD900010	10	41			10
GD900012	12	42			10
GD900013	13	42			10

GD97



Innesto Germania con dado fresato

German connection with milled nut
Kupplungen Deutschland mit Mutter

Codice/Code	L				
GD970000	44				10

GD95



Innesto Germania baionetta

German bayonet connection
Kupplungen Deutschland mit Bajonett

Codice/Code	L				
GD950000	30				10