

Dati tecnici dei giunti Italia

Italian couplings technical data
Technische Daten der Kupplungen Italien

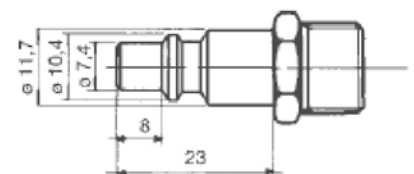

Fluido Aria compressa	Fluid Compressed air	Fluid Druckluft
Pressione di esercizio Da 0 a 12 Bar	Working pressure From 0 to 12 Bar	Betriebsdruck Von 0 bis 12 bar
Portata aria 1600 l/min.	Air flow 1600 l/min.	Luftstrom 1600 l/min.
Materiali Ottone ed acciaio	Materials Brass and steel	Werkstoffen Messing und Stahl
Filettatura BSPP cilindrica da 1/8" a 1/2"	Thread types BSPP cylindrical from 1/8" to 1/2"	Gewinde typ BSPP zylindrisch von 1/8" bis 1/2"



Foro interno d. 5,0 mm
Internal hole d. 5,0 mm

Giunti automatici

Push-in couplings
Schnellkupplungen

GN 10



Giunto Italia maschio
Italian male quick coupler
Kupplungen Italien

Codice/Code	F"	L	CH		
GN100018	G1/8	50	19		10
GN100014	G1/4	52	19		10
GN100038	G3/8	52	19		10
GN100012	G1/2	55.5	22		10

GN 50



Giunto Italia portagomma
Italian quick coupler for rubber hose
Schlauchtulle Kupplungen Italien

Codice/Code	ØT	L	CH	CH1	
GN500610	6x10	70	19	15	10
GN500612	6x12	70	19	15	10
GN500613	6x13	70	19	16	10
GN500614	6x14	70	19	17	10
GN500716	7x16	70	19	19	10
GN500812	8x12	70	19	15	10
GN500813	8x13	70	19	16	10
GN500815	8x15	70	19	18	10
GN500817	8x17	70	19	20	10
GN501015	10x15	76	19	18	10
GN501017	10x17	76	19	20	10
GN501019	10x19	76	19	22	10

GN 20



Giunto Italia femmina
Giant female quick coupler
Kupplungen Italien

Codice/Code	F"	L	CH		
GN200018	G1/8	52	19		10
GN200014	G1/4	52	19		10
GN200038	G3/8	55	19		10
GN200012	G1/2	55	25		10

GN 60

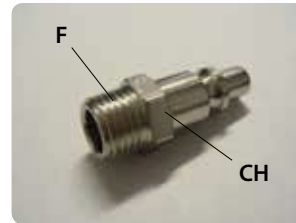

Innesto maschio Italia
Italian male connection
Kupplungen Italien

Codice/Code	F"	L	CH		
GN600018	G1/8	34.5	13		10
GN600014	G1/4	38	14		10
GN600038	G3/8	38.5	17		10
GN600012	G1/2	42	22		10

GN 30



Giunto Italia con molla
Italian female quick coupler
Kupplungen Italien mit Feder

Codice/Code	ØT	L	CH	CH1	
GN300406	4x6	118	19	12	10
GN300508	5x8	140	19	13	10
GN300608	6x8	140	19	13	10
GN306510	6.5x10	140	19	15	10
GN300810	8x10	140	19	15	10
GN300812	8x12	146	19	17	10
GN301012	10x12	146	19	17	10

GN 60T

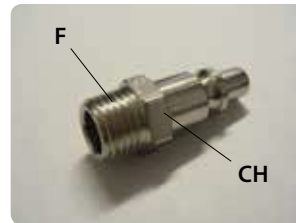

Innesto maschio Italia (acciaio)
Italian male connection (steel)
Kupplungen Italien (Edelstahl)

Codice/Code	F"	L	CH		
GN600018T	G1/8	34.5	13		10
GN600014T	G1/4	38	14		10
GN600038T	G3/8	38.5	17		10
GN600012T	G1/2	42	22		10

GN 40

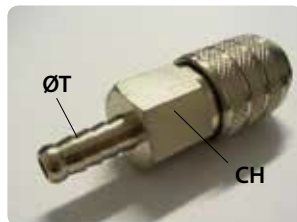

Giunto Italia con resca
Italian quick coupler with tail
Kupplungen Italien mit Abschluss

Codice/Code	ØT	L	CH		
GN400006	6	60	19		10
GN400007	7	60	19		10
GN400008	8	64	19		10
GN400009	9	64	19		10
GN400010	10	64	19		10
GN400011	11	64	19		10
GN400012	12	64	19		10
GN400013	13	64	19		10
GN400014	14	64	19		10

GN 600R

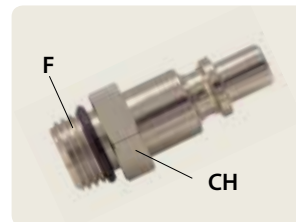

Innesto maschio Italia con O-ring
Italian male connection with O-ring
Kupplungen Italien mit O-Ring

Codice/Code	F"	L	CH		
GN6000140R	G1/4	36.5	15		10

GN70

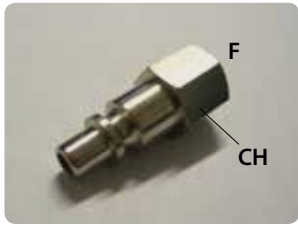

Innesto Italia femmina
Italian female connection
Kupplungen Italien

Codice/Code	F"	L	CH		
GN700018	G1/8	29	13		10
GN700014	G1/4	36.5	15		10
GN700038	G3/8	38.5	19		10
GN700012	G1/2	42	25		10

GN90



Innesto Italia con resca
Italian connection with tail
Kupplungen Italien mit Abschluss

Codice/Code	ØT	L			
GN900006	6	42			10
GN900007	7	42			10
GN900008	8	45			10
GN900010	10	45			10
GN900012	12	48			10

GN70T

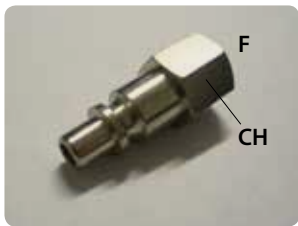

Innesto Italia femmina (acciaio)
Italian female connection (steel)
Kupplungen Italien (Edelstahl)

Codice/Code	F"	L	CH		
GN700018T	G1/8	29	13		10
GN700014T	G1/4	36.5	15		10
GN700038T	G3/8	38.5	19		10

GN95



Innesto Italia baionetta
Italian bayonet connection
Kupplungen Italien mit Bajonett

Codice/Code	L				
GN950000	35.5				10

GN80

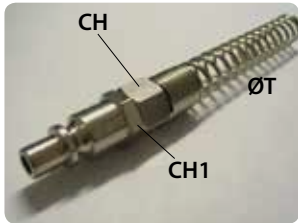

Innesto Italia con molla
Italian spring connection
Kupplungen Italien mit Feder

Codice/Code	F"	L	CH	CH1	
GN800406	4x6	100	13	12	10
GN800508	5x8	120	13	13	10
GN800608	6x8	120	13	13	10
GN806510	6.5x10	120	13	15	10
GN800810	8x10	120	13	15	10
GN800812	8x12	125	15	17	10
GN801012	10x12	125	15	17	10

GN97



Innesto Italia con dado fresato
Italian connection with milled nut
Kupplungen Italien mit Mutter

Codice/Code	L				
GN970000	46				10

GN85

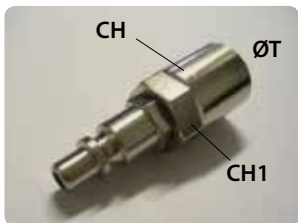

Innesto Italia portagomma
Italian connection for rubber tube
Schlauchtulle Kupplungen Italien

Codice/Code	ØT	L	CH	CH1	
GN850610	6x10	55	13	15	10
GN850612	6x12	55	13	15	10
GN850613	6x13	55	13	16	10
GN850614	6x14	55	13	17	10
GN850716	7x16	55	13	19	10
GN850812	8x12	55	13	15	10
GN850813	8x13	55	13	16	10
GN850815	8x15	55	13	18	10
GN850817	8x17	55	13	20	10
GN851015	10x15	58	13	18	10
GN851017	10x17	58	13	20	10
GN851019	10x19	58	13	22	10